



Metalbilt Fyresafe Sliding Fire Doors

Applications

Plant and machinery rooms, Hospitals, Schools, Hotels, Council Buildings, Substations, Record and Document Stores, Dangerous Goods Stores, Switch Rooms, openings where hinged doors are impractical.

Features

- Up to -/240/60 F.F.R. (four hours integrity and one hour insulation)
- Maximum opening size – 5.4m high x 7.8m wide (subject to weight limitations)
- Facing options – Plywood (Paint Quality) or Steel (Zintec)
- Door leaves overlap opening by 100mm at head and at jambs
- Available as single leaf or Bi-parting pairs
- Installation in masonry or 60/60/60 timber stud walls approved
- Activation options
 - Fusible Link
 - Electro magnetic (activated by alarm)
 - Motorised

50 years of manufacturing experience and continuous refinement.
Service and repairs, 24 hours a day, on all makes of commercial doors.

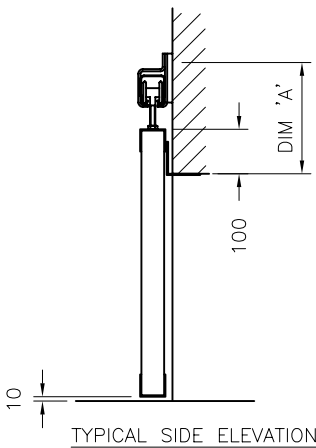
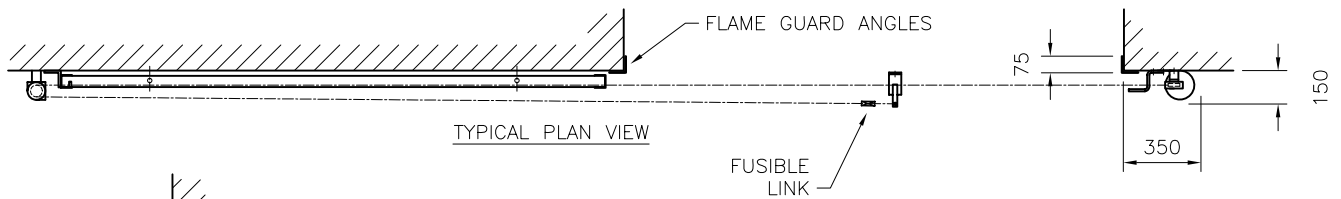

TRACK SELECTION: (Confirm with Weight Tables)

HENDERSON TRACK	DIM 'A'	HEADROOM	MASONRY WALL	TIMBER STUD WALL
301	270	265mm	Up to 450kg leaf	Up to 200kg leaf
305	305	320mm	450 – 700kg leaf	200 – 310kg leaf
307	335	355mm	Over 700kg leaf	310 – 890kg leaf

Approximate weight = 35kg/m² (refer to weight tables)

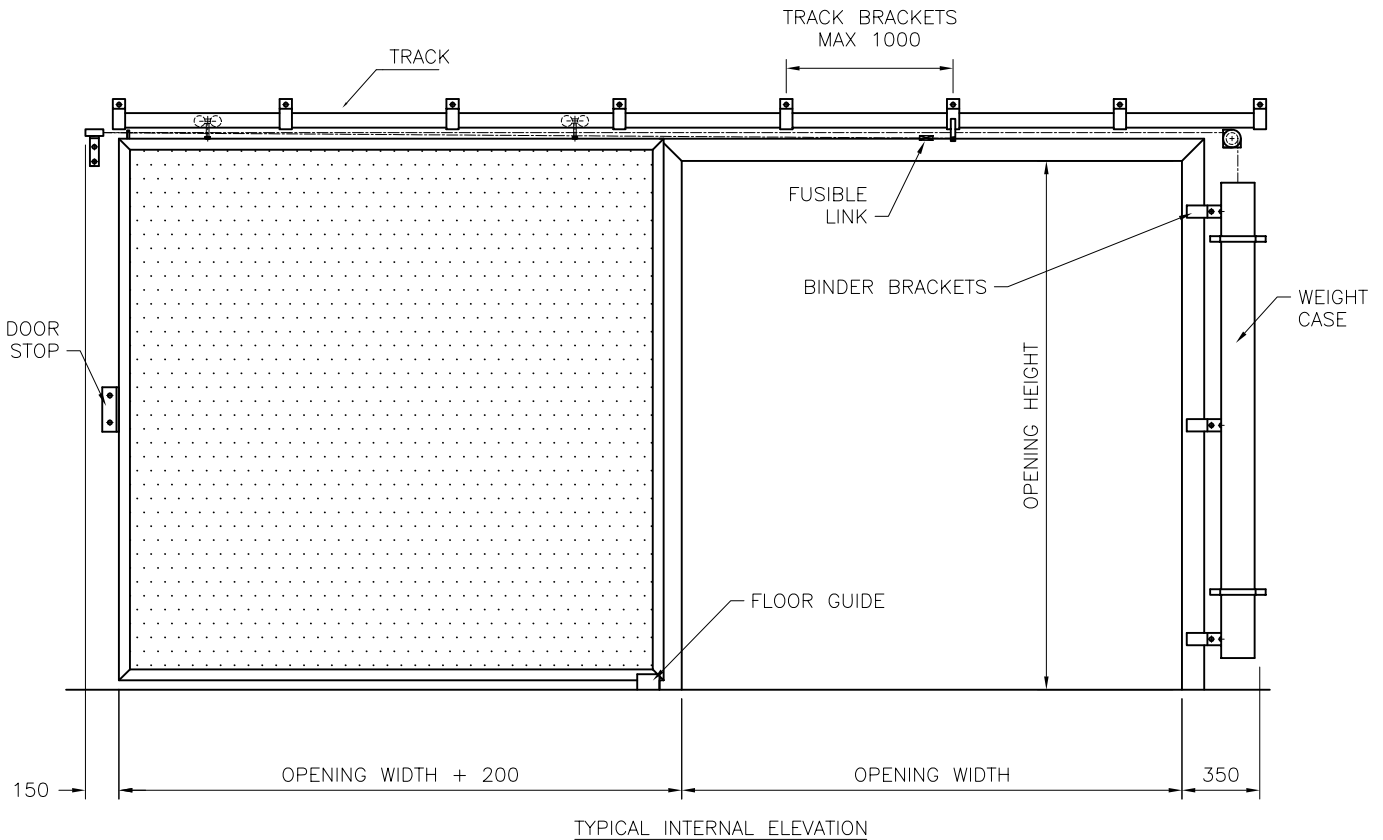

DOOR OPERATING OPTIONS

- a. DOOR ALWAYS CLOSED (counter weight closing)
- b. DOOR ALWAYS OPEN (door held open until activated)
- c. DOOR FREQUENTLY OPENED & CLOSED (opens & closes freely until activated)

We reserve the right to alter specification without notice and without incurring obligation

Standard doors meet the 5 year durability requirements of the N.Z.B.C. Details available on request.



Auckland
 PO Box 71 169 Rosebank
 26 Timothy Place, Avondale
 Telephone 09 828 1167
 Fax 09 828 6358
 mbilt.auck@metalbilt.co.nz

Wellington
 PO Box 38 933 W.M.C.
 55 Cuba Street, Petone
 Telephone 04 568 2933
 Fax 04 568 7337
 mbilt.well@metalbilt.co.nz

Christchurch
 PO Box 6033 Riccarton
 60 Lunns Roads, Middleton
 Telephone 03 338 2600
 Fax 03 338 4386
 mbilt.chch@metalbilt.co.nz